

# PEMA<sup>®</sup>

Sampling valve with Membrane for tanks or process lines and low viscosity liquids

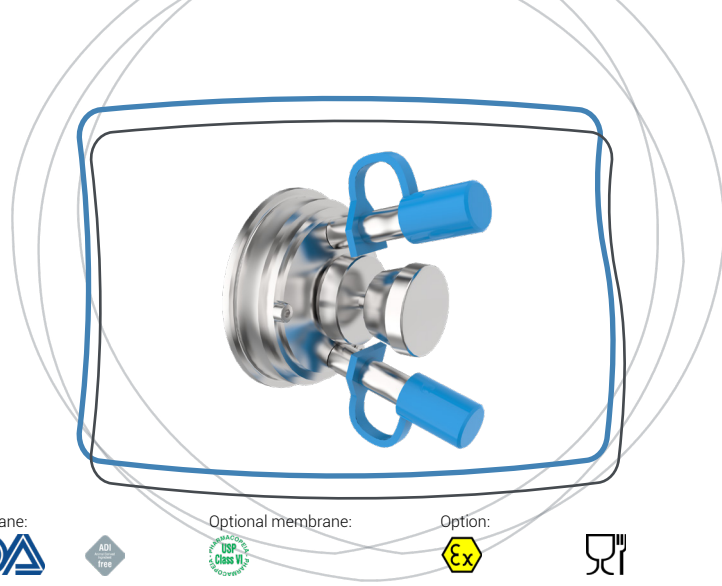

## Presentation

Membrane:  
**FDA**



Optional membrane:  
**USP Class VI**

Option:  
**Ex**



The PEMA sampling valve is used to take a sample of clear or low-viscosity liquid from a tank, in order to carry out quality and/or bacteriological tests. The valve has a dedicated connection for the flow of CIP fluid, enabling the sampling chamber to be cleaned. The valve is sealed by a membrane. Its hygienic design ensures that there are no retention areas (where bacteria can develop), and that it is easy to clean. Its hygienic qualities, as well as its ease of installation and maintenance, make it a market reference.

## Key features

- Hygienic design with completely flush body and the option of mounting on VARIVENT flush-mount supports
- Ease of use and maintenance
- Can be sterilised by CIP/SIP circulation

## Applications

- On-tank sampling of clear or low-viscosity liquids (manual version)
- On-tank sampling of a sticky, sugary, low-solidification rate, low-viscosity or clear liquid (automatic version or SEKURIT manual version or lever)
- Equipment particularly suited to sampling products subject to quality and/or bacteriological tests

## Technical features

**Sizes:** DN 6 and DN 10

**Inlet fitting:** SVX flush welding body

**Outlet fitting:** Plain nozzle with VMQ cap (Silicone)

**CIP connection:** Plain nozzle with VMQ cap (Silicone)

**Operating pressure:** From 0.1 to 6.0 bar (0 to 10 bar for the PEMS SEKU version)

**Operating temperature:** From 0°C to 120°C

**Withstands CIP/SIP:** Up to 130°C for 20 to 30 minutes

## Materials

- Parts in contact with the product: Stainless steel 1.4404 (316L)
- Other parts: Stainless steel 1.4301 (304L)
- Sealing: VMQ (Silicone) membrane

## Dimensions in mm

Sizes	ØA	B	ØC	ØD	E°
DN 6	100	45	30	91	75
DN 10	110	65	38	101	75

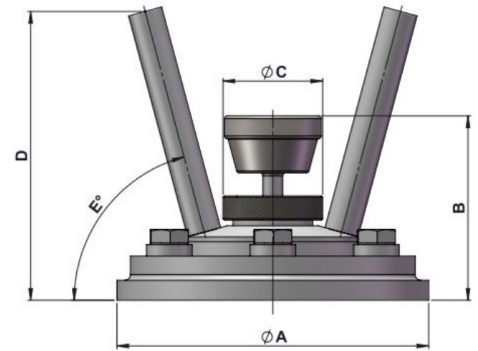

## Options

- Mounting on SVX flush flange or clamp or H-Connect flush bracket
- Fitted membrane head (lever or SEKURIT type)
- Automatic or hybrid version (automatic + manual)
- Valve without CIP connection for flame sterilisation
- Stainless steel caps on outlets with threaded ends
- Special connections on request (e.g. aseptic alligator type quick-fit couplings)
- Other membranes: EPDM (Ethylene Propylene Diene Monomer), NBR (Nitrile rubber), FKM (Fluorocarbon rubber, eq. Viton®), FFKM (eq. Kalrez®)

## Warranty

12 months as from the date of dispatch (except for special conditions)

## Conformity

- Tank fitting compliant with Paragraph 4.3 of the PED 2014/68/EU
- Option: "ATEX 2014/34/EU, zones 1 & 2, gas and dust" compliant for automatic versions
- Elastomer membranes compliant with FDA CFR 21.177.2600 and Regulation (EC) 1935/2004
- Option: Membranes compliant with USP Class VI